

# PLAT OF SURVEY

## LOT 25 OF DUTCH MEADOWS SUBDIVISION

LOCATED IN THE NW 1/4 OF SECTION 31, TOWN 2 NORTH,  
RANGE 16 EAST, WALWORTH COUNTY, WISCONSIN

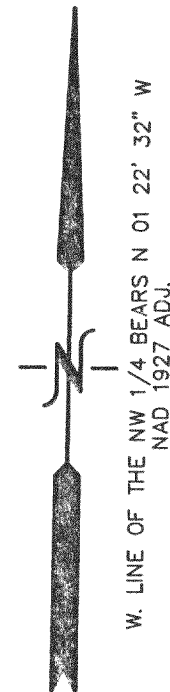

LOT 26

**LOT 25**  
57,992 S.F.  
(1.33 AC.)

BUILDING AREA

**WINDMILL WAY**  
66' WIDE PUBLIC R.O.W.

S 56-21-41.5 E  
35.75  
R = 267.00  
A = 35.78

LEGEND  
● = FOUND IRON REBAR STAKE  
□ = FOUND CONCRETE COUNTY MONUMENT W/BRASS CAP  
{XXX} = RECORDED AS

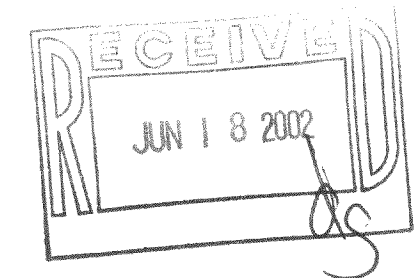

NOTE: COPIES OF THIS MAP TO WHICH THE FOLLOWING CERTIFICATE WILL APPLY SHOW THE SURVEYOR'S ORIGINAL SEAL AND SIGNATURE IN RED INK. COPIES BY ANY OTHER MEANS MAY HAVE ALTERATIONS WHICH DO NOT REPRESENT THE SURVEYOR'S WORK PRODUCT.

I HEREBY CERTIFY THAT THE ABOVE DESCRIBED PROPERTY HAS BEEN SURVEYED UNDER MY DIRECTION AND THAT THE ABOVE MAP IS A TRUE REPRESENTATION THEREOF AND SHOWS THE SIZE AND LOCATION OF THE PROPERTY AND ITS EXTERIOR BOUNDARIES. THIS SURVEY IS MADE FOR THE USE OF THE PRESENT OWNERS OF THE PROPERTY, AND ALSO THOSE WHO PURCHASE, MORTGAGE, OR GUARANTEE THE TITLE THERETO WITHIN ONE YEAR FROM THE DATE HEREOF.

DATED: 06/07/2002

*Peter S. Gordon*  
PETER S. GORDON R.L.S. 2101

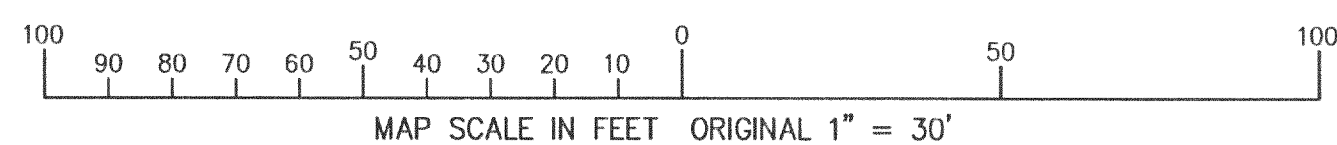

JUN 07 2002

FDut-25 216-3205

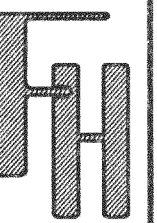

**DUTCH MEADOWS SUBDIVISION**  
PLAT OF SURVEY - LOT 25

WORK ORDERED BY -  
4D DEVELOPMENT, LLC  
11013 122nd STREET  
PLEASANT PRAIRIE, WI. 53158

**FARRIS, HANSEN & ASSOCIATES, INC.**  
ENGINEERING - ARCHITECTURE - SURVEYING  
7 RIDGWAY COURT P.O. BOX 437  
ELKHORN, WISCONSIN 53121  
OFFICE: (262) 723-2098 FAX: (262) 723-6886

REVISIONS

PROJECT NO.  
5139.25  
DATE:  
02/08/2002  
SHEET NO.  
1 OF 1